

MINIATURE MICROSWITCHES - POSITIVE BREAK

832607

- › Coil spring snap-action mechanism with wiping contacts
- › Positive opening action according to IEC 60947-5-1 Annex K
- › 6 A 250 V \sim max rating
- › Operating temperature -40 °C to +125 °C
- › Very long life
- › Extended range of terminals - Stainless steel actuators
- › cURus and CCC approved



Main specifications

| Main specifications | | Positive break 832607 |
|-------------------------------------|--------------------|--------------------------|
| Function | Connections | |
| I (changeover) | W2 (solder) | 83260702 |
| I (changeover) | W3 (QC 6.3x0.8) | 83260704 |
| I (changeover) | W6 (QC 4.8x0.5) | 83260706 |
| I (changeover) | W5 (screw + clamp) | ● |
| I (changeover) | X1 (PCB, straight) | 83260765 |
| I (changeover) | X2 (PCB, rear) | 83260768 |
| I (changeover) | X3 (PCB, front) | 83260708 |
| R (normally closed) | W2 (solder) | 83260701 |
| R (normally closed) | W3 (QC 6.3x0.8) | 83260703 |
| R (normally closed) | W6 (QC 4.8x0.5) | 83260705 |
| R (normally closed) | W5 (screw + clamp) | ● |
| R (normally closed) | X2 (PCB, rear) | 83260732 |
| R (normally closed) | X3 (PCB, front) | 83260707 |
| Electrical characteristics | | |
| Positive opening action | | → |
| Rating nominal / 250 V \sim (A) | | 6 |
| Thermal current (Ith) (A) | | 10 |
| Mechanical characteristics | | |
| Maximum operating force (N) | | 4 |
| Min. Release force (N) | | 1.5 |
| Minimum positive opening force (N) | | 18 |
| Max. Allowable overtravel force (N) | | 200 |
| Rest position max. (mm) | | 15.7 |
| Operating position (mm) | | 14.8 \pm 0.3 |
| Positive opening position (mm) | | 13.5 |
| Maximum differential travel (mm) | | 0.3 |
| Min. overtravel (mm) | | 1.3 |
| Ambient operating temperature (°C) | | -40 → +125 |
| Mechanical life (operations) | | 10 ⁷ |
| Contact gap (mm) | | 1.2 |
| Weight (g) | | 7 |

Additional specifications

- Case: PET GF (UL 94-V0 / GWFI 960 °C / GWIT 775 °C)
- Button: PA66 GF (UL 94-V0 / GWFI 960 °C)
- Contacts: silver alloy
- Terminals: brass (except W2/X: copper nickel), silver plated common
- Levers: stainless steel, polyamide roller
- Degree of protection: IP40 (mechanism)
- Recommended actuating speed: 0.25 mm/s to 0.5 m/s
- Rated insulation voltage Ui: 250 V
- Impulse withstand voltage Uimp: 4 kV
- Certification marks:

Product adaptations



- › Special levers: special shapes and lengths
- › Lever mounted on position A for higher ratio
- › Special connections: angled, full wiring with custom connector....

Standard product

Product made to order



Contact us

Principles

Single break snap-action switch with positive opening action on NC contacts (1-2) according to IEC 60947-5-1 Annex K
 Changeover - SPDT (form C) Normally closed - SPST-NC (form B)

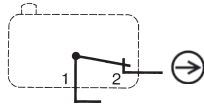
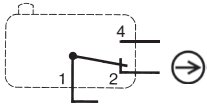

Curves

Electrical life

- Resistive load: 250 V~ 6 A: 10⁵ cycles
- Inductive load (IEC 60947-5-1) : AC15: 250 V~ 6 A: 0.3 x 10⁵ cycles
 DC13: 24 V--- 20 W L/R = 40 ms: 3 x 10⁵ cycles
 120 V--- 20W L/R = 40 ms: 5 x 10⁵ cycles

Dimensions

Product

832607

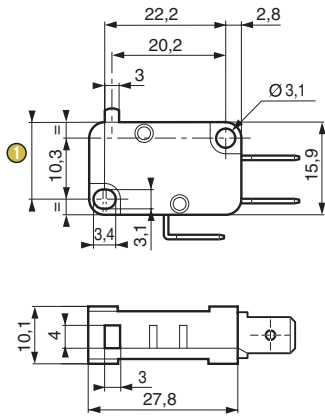

① Total travel position = 13.2 max.

Connections

W2 solder

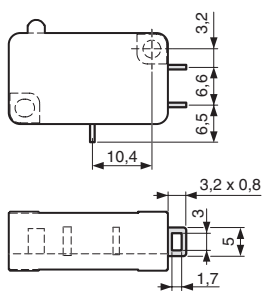

W3 quick-connect 6.3 x 0.8

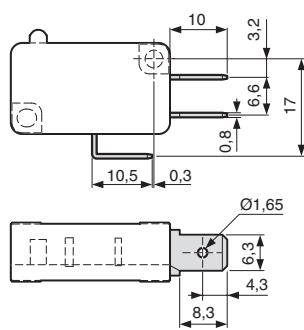

W5 screw with clamp

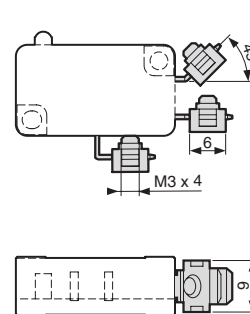

W6 quick-connect 4.8x0.5

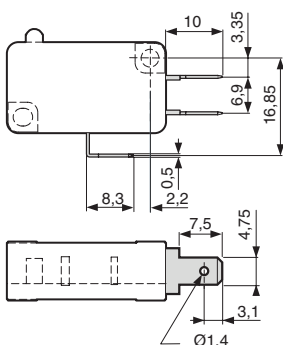

X1 for PCB, straight output

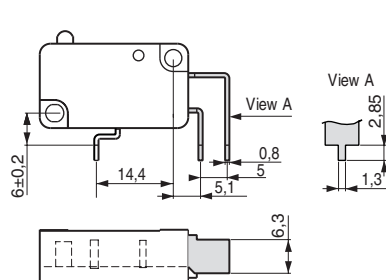

X2 for PCB, rear output

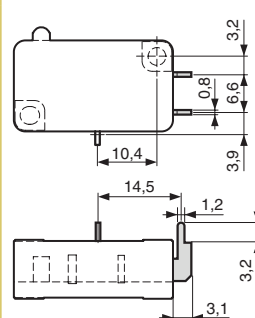

X3 for PCB, front output

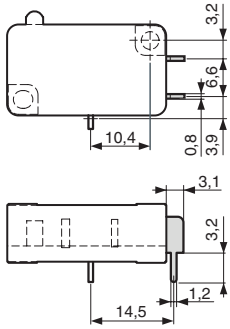

Actuator mounting position

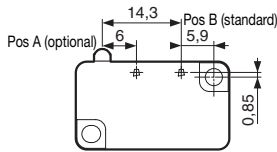

Actuators

260A flat

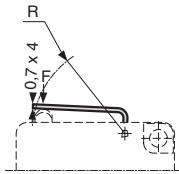

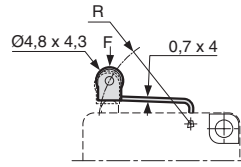

260E roller



Other shapes and dimensions: consult us

Actuators and mounting accessories

| Actuators | | Flat 260A R16.8 | Roller 260E R16 |
|-------------------------------|----|--|---|
| | |  |  |
| Operating force - max. | N | 4 | 4 |
| Release force - min. | N | 1 | 1 |
| Min. positive opening force | N | 18 | 18 |
| Maximum rest position | mm | 16.4 | 21.5 |
| Operating position | mm | 15.5 ±0.3 | 20.6 ±0.45 |
| Positive opening position | mm | 14.2 | 19.3 |
| Maximum total travel position | mm | 14.1 | 19.2 |

Levers are assembled in our factories

832607 microswitches with referenced actuators

| | Actuators | 260A R16.8 Pos B | 206E R16 Pos B |
|---------------|-----------|------------------|----------------|
| 832607 | I W2 | ● | 83260735 |
| | I W3 | ● | 83260710 |
| | I W5 | ● | 83260764 |
| | I X3 | ● | 83260736 |
| | R W2 | ● | 83260734 |
| | R W3 | ● | 83260711 |
| | R W5 | ● | ● |
| | R X3 | ● | 83260714 |

Installation recommendations

See "Basic technical concepts"

How to order

Use the 8 digit part numbers when they are defined

Other cases, precise: Type of microswitch - Function - Connection - Actuator* - Fixing position*

* if needed

Example: 832607 R W2 260A R16.8 B

Standard product

Product made to order



Contact us

Warning:

The product information contained in this catalogue is given purely as information and does not constitute a representation, warranty or any form of contractual commitment. Crouzet Automatismes SAS and its subsidiaries reserve the right to modify their products without notice. It is imperative that we should be consulted over any particular use or application of our products and it is the responsibility of the buyer to establish, particularly through all the appropriate tests, that the product is suitable for the use or application. Under no circumstances will our warranty apply, nor shall we be held responsible for any application (such as any modification, addition, deletion, use in conjunction with other electrical or electronic components, circuits or assemblies, or any other unsuitable material or substance) which has not been expressly agreed by us prior to the sale of our products.